

Potter County.

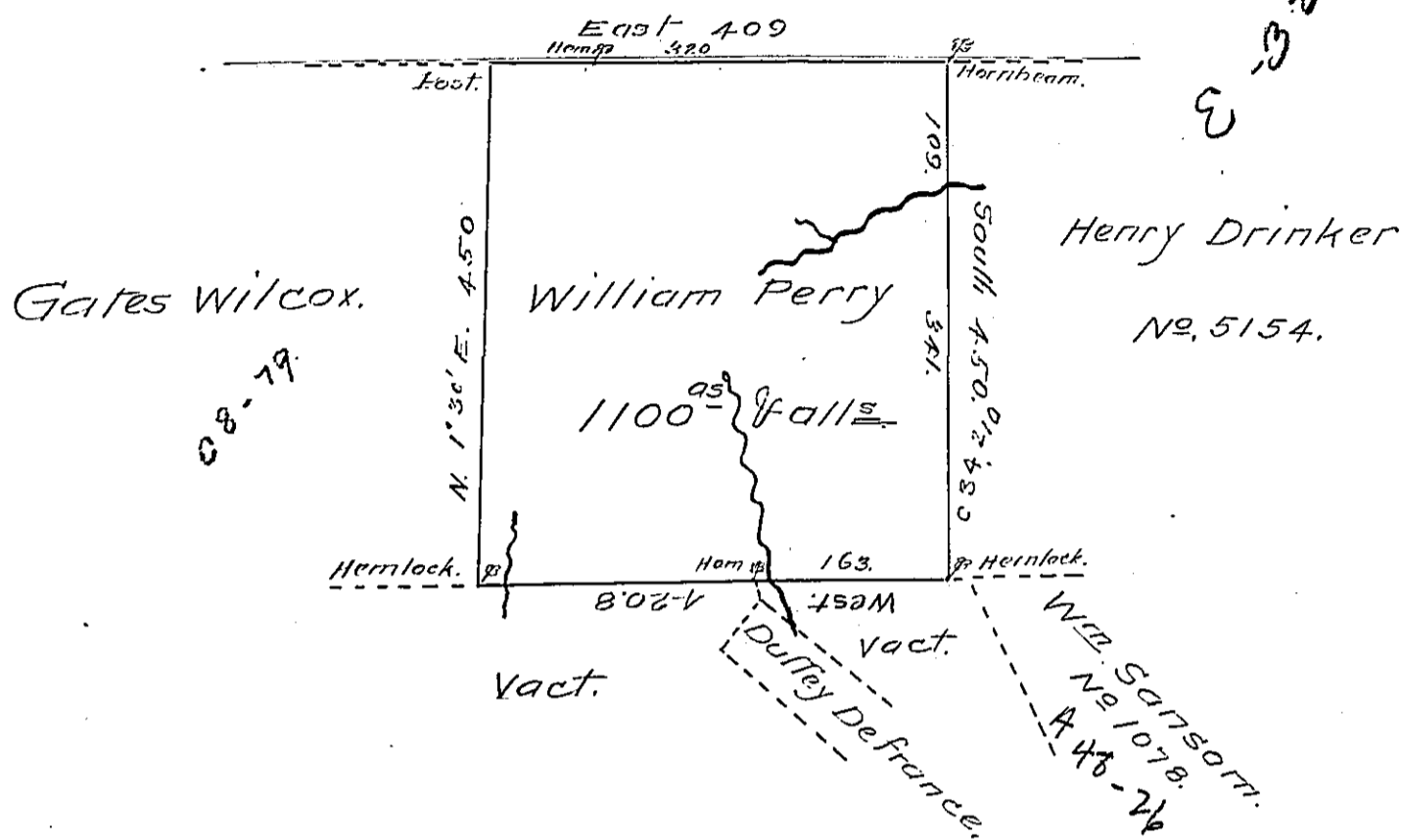

Situate in Chapman Township County of Clinton (late Lycoming) near the first fork of Kettle-on the North west side of said Creek and bounded as above discribed, Surveyed to William Perry on the 30th day of July 1839 by virtue of his warrant for 1000 acres dated the 26th day of December 1838 Containing one thousand one hundred acres with allowance of Six per Cent for Roads &c.

Alexander H. McHenry D.S.
Michael Sour D.S. Clinton Co.

To Jacob Sallade Esquire }
Surveyor General }

IN TESTIMONY that the above is a copy of the original remaining on file in the Department of Internal Affairs of Pennsylvania, made conformably to an Act of Assembly approved the 16th day of February, 1833, I have hereunto set my Hand and caused the Seal of said Department to be affixed at Harrisburg, this Twenty ninth day of June 1906.

Quac N. Brown
Secretary of Internal Affairs.